

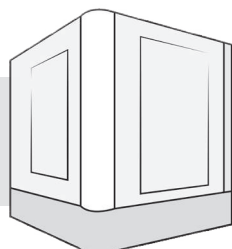

PackshotCreator R3 Mark II
QuickStart
INSTALLATION GUIDE

PackshotCreator R3 Mark II

PACKAGE COMPOSITION



PackshotCreator Mini
Mark II lightbox

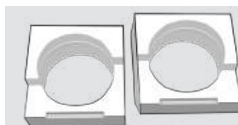

2 camera mount
sponges



Product Registration Sheet
& Quick Reference Guide

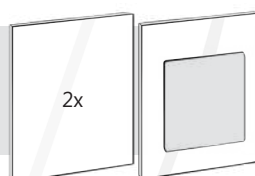

3 acrylic panels



1 power cable

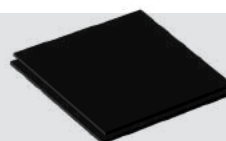

2 sheet blacks
PVC



1 USB cable



2 reflective door
covers

© Sysnext. All rights reserved.

This material is not to be interpreted as a guarantee of earnings and may not be copied, reproduced, modified, published, uploaded, posted or distributed in any way, without PackshotCreator's prior consent.

PackshotCreator R3 Mark II

SPECIFICATIONS

	<i>PackshotCreator R3L Mark II</i>	<i>PackshotCreator R3M Mark II</i>
Dimension (L x W x H):	115cm x 100cm x 123cm	100cm x 76cm x 97cm
Maximum Target Size <i>Top Shots:</i>	51cm x 51cm	36cm x 36cm
<i>Side Shots:</i>	51cm x 51cm x 75cm	36cm x 36cm x 58cm
Total Weight:	32 kg	32 kg
Maximum Object Weight:	20.4 kg	

CONTACT INFO:

Email: help@packshot-creator.com

Website: <http://esupport.packshot-creator.com>

PackshotCreator R3 Mark II

SYSTEM PLACEMENT

ROLLING THE UNIT:

01

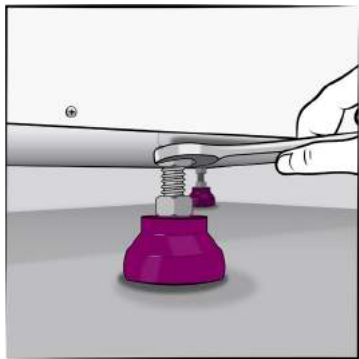

Use the #24 wrench to adjust leg height. Start by loosening the top nut.

02

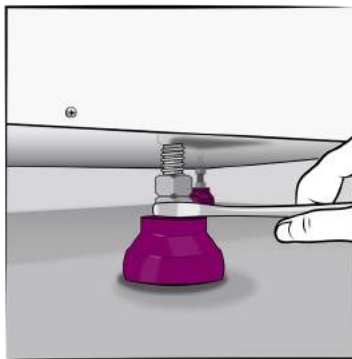

Rotate the bottom nut to raise or lower the leg.

03

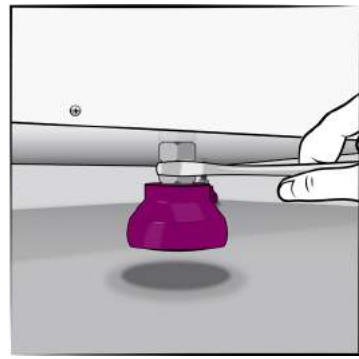

When all legs are up, roll the unit into position. Lower the legs, balance the unit, then re-tighten the top nut against the bottom of the unit.

GUIDING THE UNIT THROUGH A DOORWAY:

01



If the doorway is less than 115cm wide, you will need to remove the top, two side walls, acrylic panels, front door, two front columns, translucent turntable platform, glass turntable, and motor to get the unit through the door. See the "Component Replacement" of this document.

02



Slide the motor out from the rail and unplug the signal cable.

03

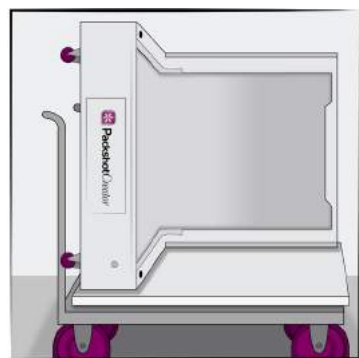

Get a dolly. Place a piece of foam on top. Place the system on its side on the dolly / foam. Lift and guide / curve the unit through the doorway.

PackshotCreator R3 Mark II

SYSTEM PLACEMENT

DISASSEMBLY:

01

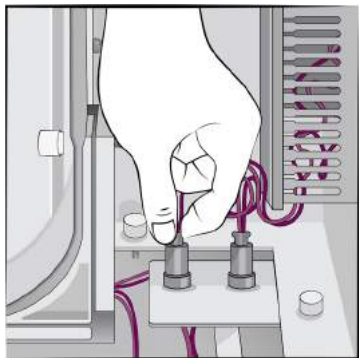

Unplug the 2 metal connectors.

02

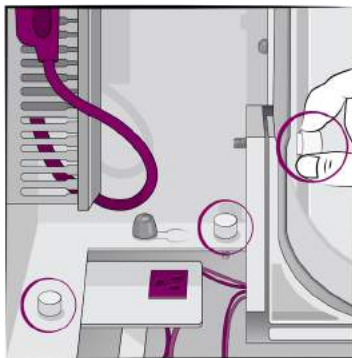

Unplug the power connector.

03

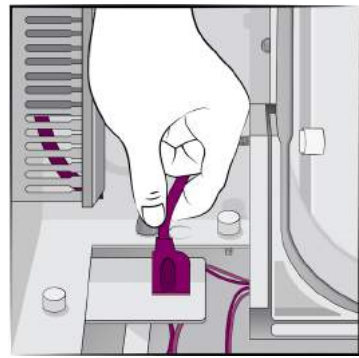

Remove 6 white hand screws, 3 on each side.

04

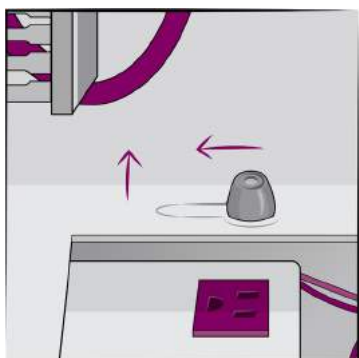

Slide the back light panel away from the 2 dowel screws, then lift up and separate completely from the bottom light panel.

05

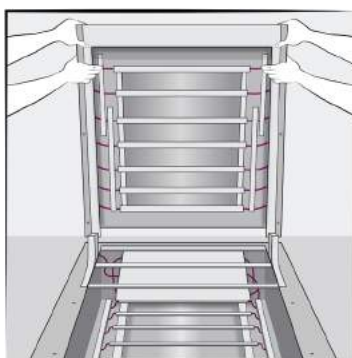

Note: The back light panel is very heavy, recommend 2-4 people.

06

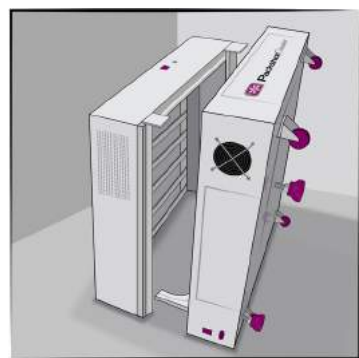

Once the 2 panels are separated, you can slide the bottom background backward and lay the bottom light panel vertically, so as to move them individually through small spaces. Reverse steps 01-05 to reattach the 2 light panels.

PackshotCreator R3 Mark II

SYSTEM PLACEMENT

PLACEMENT:

01



Place the system on the floor. Make sure the system is level and legs are locked into position.

02



(Optional): Place the system on an PackshotCreator ErgoTable (sold separately).

03

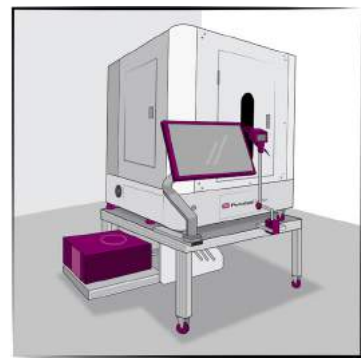

(Optional): Place the system on an PackshotCreator ErgoTable+ (sold separately).

04

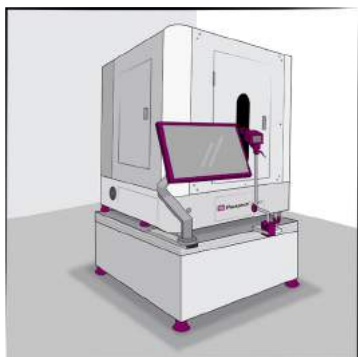

(Optional): Place the system on an PackshotCreator Supporting Box (sold separately).

05



Any external lighting, such as PackshotCreator LiveStudio light, can be used with the system when some or all of the top, two side walls, acrylic panels, front door and two front light columns are removed.

PackshotCreator R3 Mark II

HARDWARE INSTALLATION

ACRYLIC PANEL INSTALLATION 1/2:

01



Remove the two white hand screws holding the top light panel to the top.

02



Remove the top light panel from the top by sliding it to the left and take it off with caution.

03

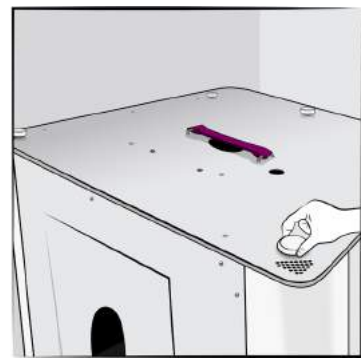

Remove the five white hand screws.

04

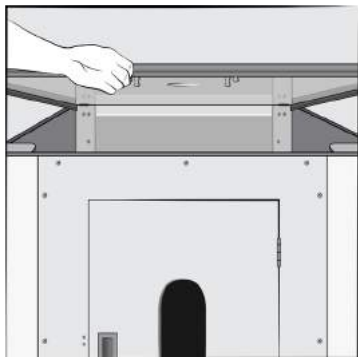

Remove the top.

05

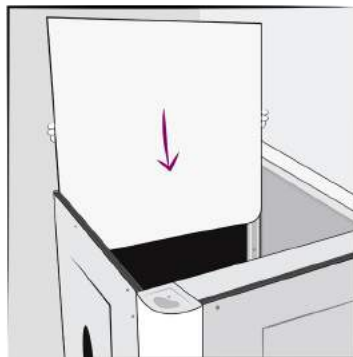

Three acrylic panels come with the system - one solid, one with an opening at center and one with a small hole at bottom. Choose which two panels to use.

06

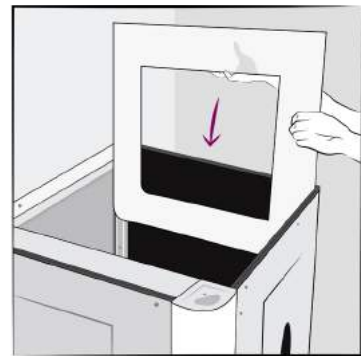

Place the one with an opening on either side for convenient side loading. Slide the panels in from the top through the two guide notches / cut outs in the holding bracket and front door.

PackshotCreator R3 Mark II

HARDWARE INSTALLATION

ACRYLIC PANEL INSTALLATION 2/2:

07

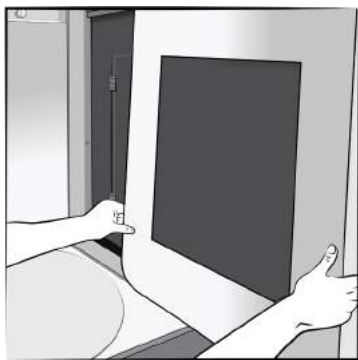

Note: Place the acrylic panel with a small hole at bottom on the left side when using a PackshotSpin O3T inside the PackshotCreator, so the power and USB cables can be strung through the small hole and then plugged into the power jack and USB port on the frame of the bottom light panel respectively.

08

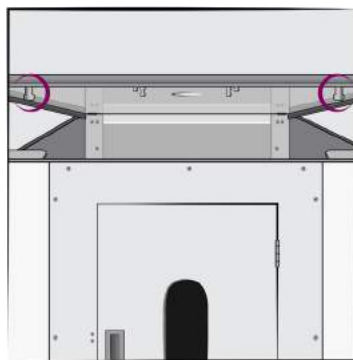

Reverse steps 01-04 to replace the top and top light.

Note: Align the acrylic panels between the metal guide brackets on the top, before tightening.

09



(Optional): The acrylic panels can also be installed through the front when the front door is detached. Insert the acrylic panels between the guide notch on the bottom.

10



Respectively insert the acrylic panels between the metal guide bracket on the top.

11



Finally slide the rest of the panel into the guide notch on the back wall holding bracket.

PackshotCreator R3 Mark II

HARDWARE INSTALLATION

CABLE CONNECTION 1/2:

01



Plug one end of the power cable into the system and the other end into a power socket.

02

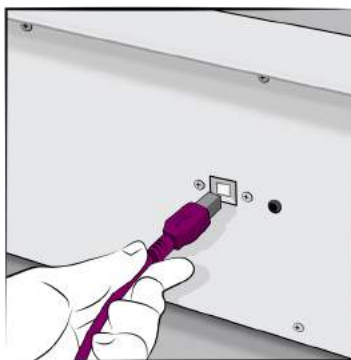

Plug one end of USB Type B cable into the system and the other end into a computer USB port.

03

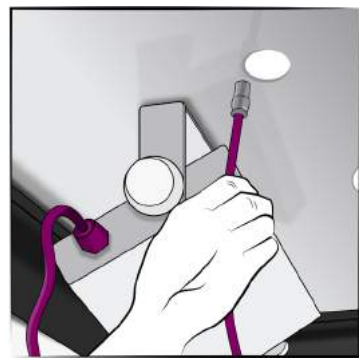

String the top light power cable through the ceiling hole.

04

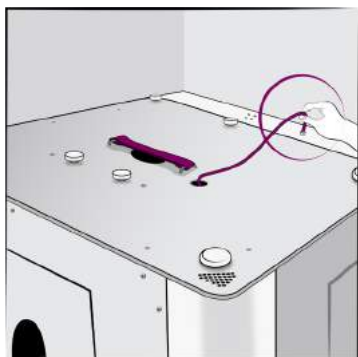

Plug it into the port on the top of the back light panel. Rotate clockwise to tighten.

05

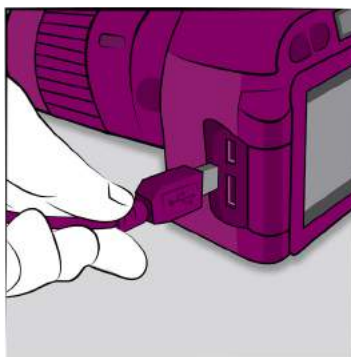

Connect a compatible camera to your computer by USB.
(Optional): Instead of batteries, we recommend using an AC power adapter to power your camera.

06

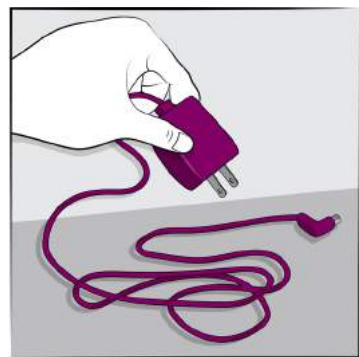

(Optional Connections): For almost all SLR cameras featuring remote capture capabilities, PackshotCompact can supply a custom shutter release cable to connect the camera to the system so software can automate image capture.

PackshotCreator R3 Mark II

HARDWARE INSTALLATION

CABLE CONNECTION 2/2:

07

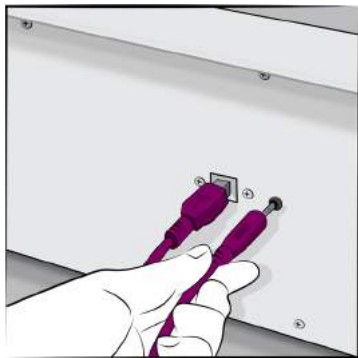

In this configuration, captured images are saved to the memory card.

08

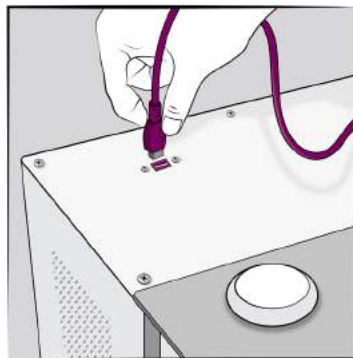

If you are using camera top shot, plug the USB cable from your camera to your computer directly, or into the USB port on the top of the back light panel first.

09



Respectively, plug one end of the USB Type A cable into the left side of the back light panel and the other end into your computer USB port.

10

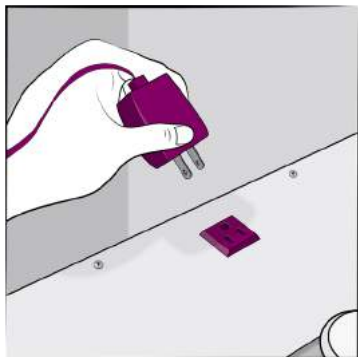

(Optional): If you are using AC power adapter, plug it into the power socket on the top of the back light panel.

11

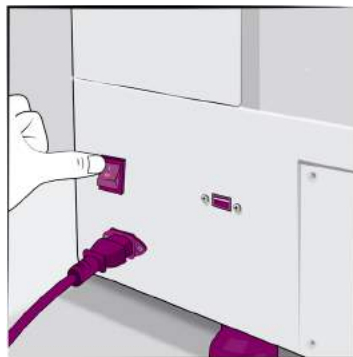

Flip the system power switch on.

12

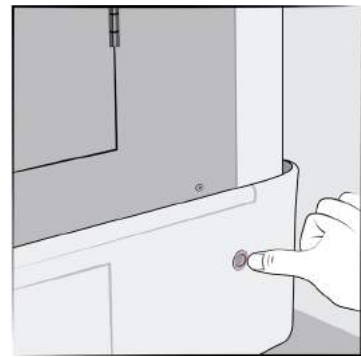

Press the metal button switch to turn on the system.

PackshotCreator R3 Mark II

CENTERING ARM (SOLD SEPARATELY)

01

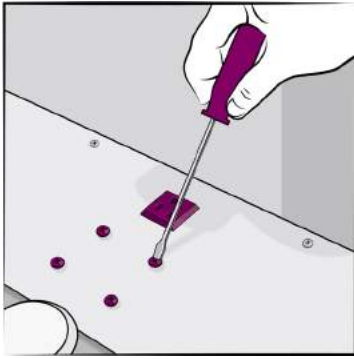

Use a Phillips screwdriver to remove the 4 black screws.

02

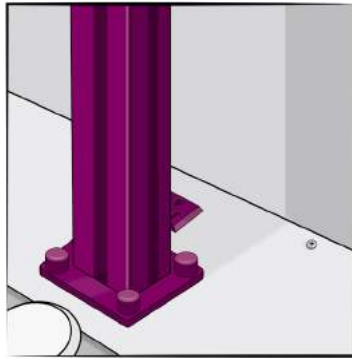

Attach the centering arm using 4 small black hand screws.

03

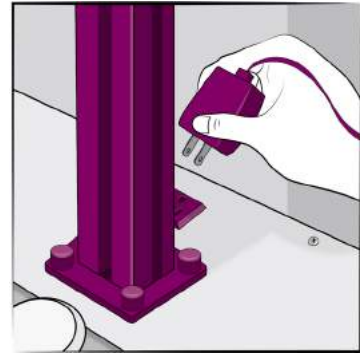

Plug in the power cable.

PackshotCreator R3 Mark II

COMPONENT REPLACEMENT

CONTROL BOARD AND POWER SUPPLY:

01

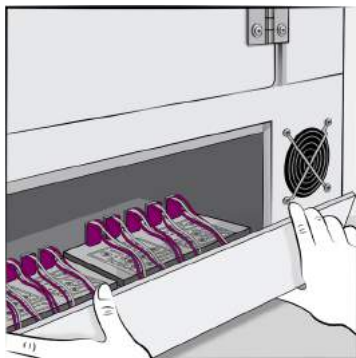

To access the control boards, unplug the studio then open the bottom panels.

02

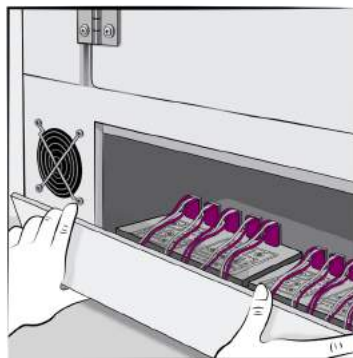

Open the bottom panel on the left, right, and the back door.

03

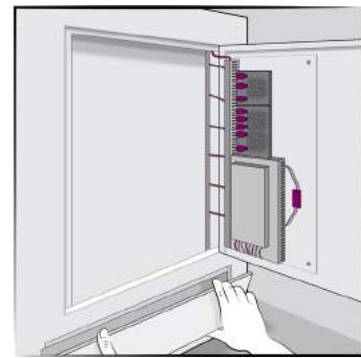

To access the power supply, unplug the studio then open the back door and bottom panel on the back of the unit.

PackshotCreator R3 Mark II

COMPONENT REPLACEMENT

ACCESS AND REMOVE THE CORNER LAMP 1/2:

01

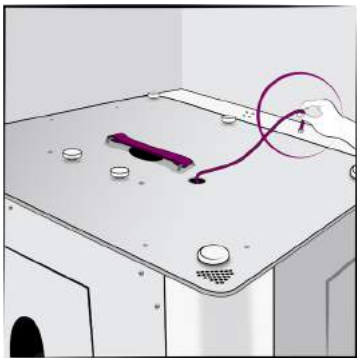

Unplug the studio and the top light power cable.

02

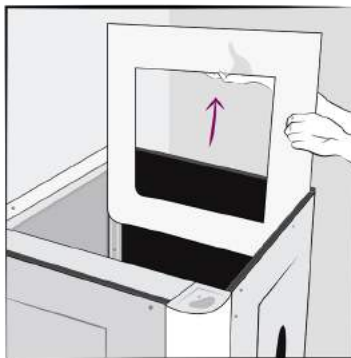

Follow instructions from steps 01-04 in the "Acrylic Panel Installation" part of this document to remove the top and top light, and then remove the acrylic panels if any.

03

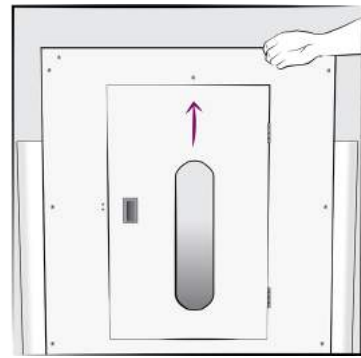

Lift to remove both side walls and front door.

04

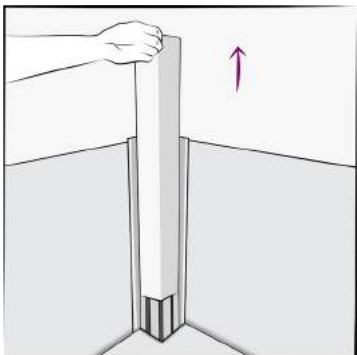

Lift to remove the diffusion plate.

05



Disconnect the connector for the LED lamps.

06

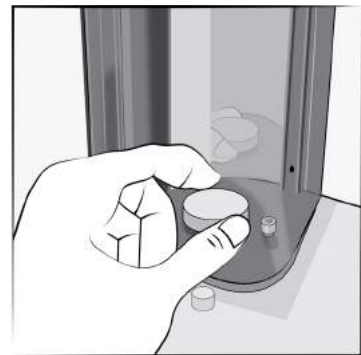

Remove the hand screw.
Note: The hex socket button screws do not need to be removed.

PackshotCreator R3 Mark II

COMPONENT REPLACEMENT

ACCESS AND REMOVE THE CORNER LAMP 2/2:

07

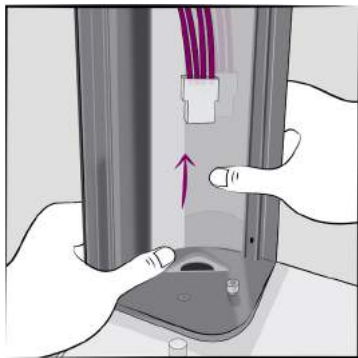

Lift to remove the column.

08

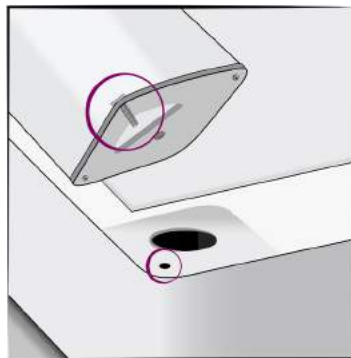

Note: When re-installing the columns, be sure to align the screw with the small corner hole.

09

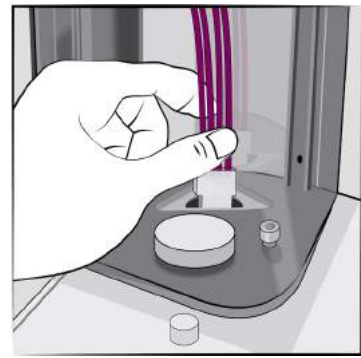

Then, tuck the connector and extra wire into the large hole.

ACCESS THE BOTTOM LAMP:

01

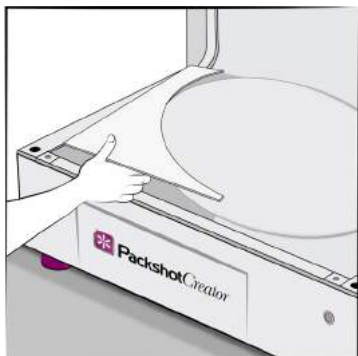

Remove the 2 small diffusion plates on the front of the machine.

02



Remove the translucent turntable platform.

03



To remove the glass turntable, hold onto the glass edge and push it towards the motor to lift it away from rollers and idlers then remove completely.

PackshotCreator R3 Mark II

COMPONENT REPLACEMENT

ACCESS THE BACK LAMP:

01

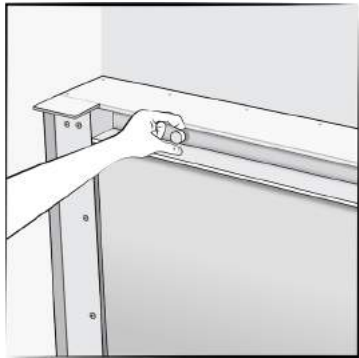

Remove 2 small white hand screws and the holding bracket on the top of the curved background.

02

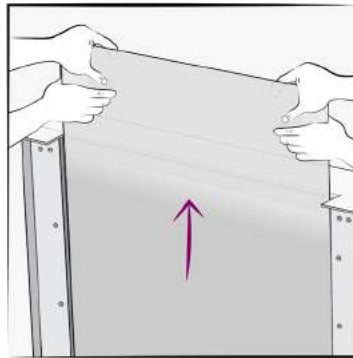

Lift to remove the curved background from the system with 2 people at opposite sides.

03

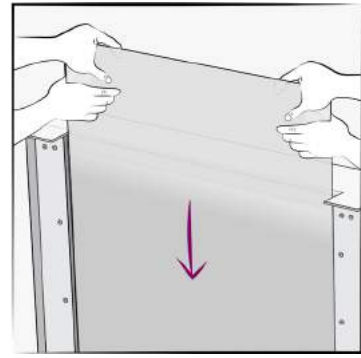

Note: When re-installing the curved background, we recommend to slide it down with 2 people at opposite sides. Use one hand to brace and guide the bottom corner into the curved rail and then press it down until it flush with the bottom background.

ACCESS THE BOTTOM CORNER LAMP:

01

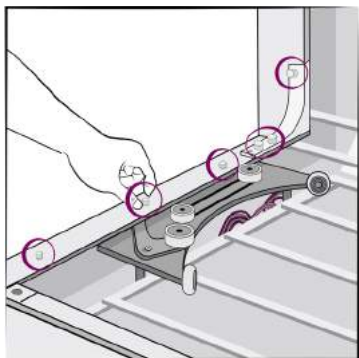

Loosen the 3 hand screws and remove the side rails. Also remove the 3 hand screws on the curved guiding rails.

02

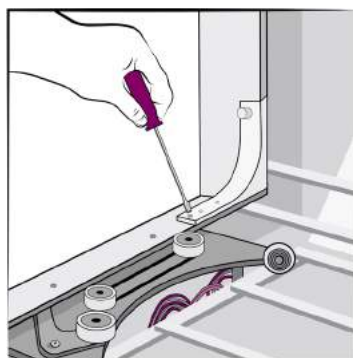

Remove the end blocks using a Phillips screwdriver.

03

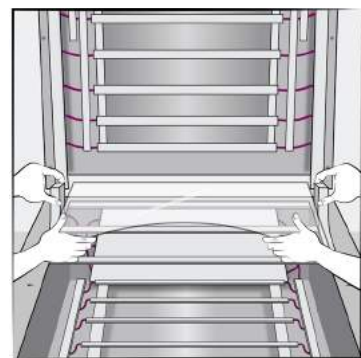

Carefully remove the bottom glass plate and curved guiding rails away from the system by lying up and forward. **Note:** We recommend 2 people one on each side holding onto the bottom glass and curved guiding rail.

PackshotCreator R3 Mark II

COMPONENT REPLACEMENT

LED LAMP REPLACEMENT:

01

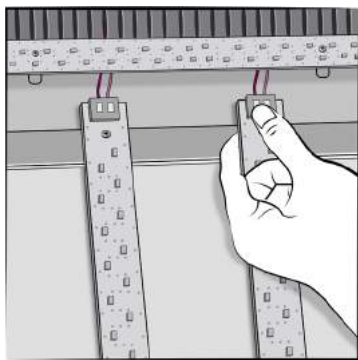

Disconnect the two wires by pressing the connector node while pulling the wire out. **Note:** The red wire is V+ and the black wire is V-.

02

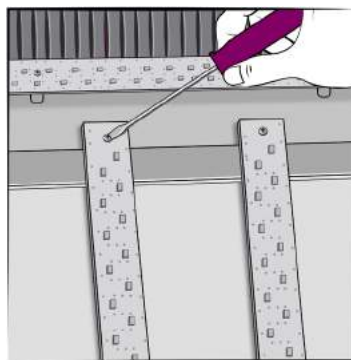

Use a Phillips screwdriver and gently remove the LED lamps.

03

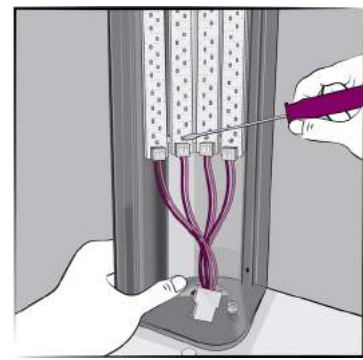

Use the same method to replace the LED lamps on the corner.

04

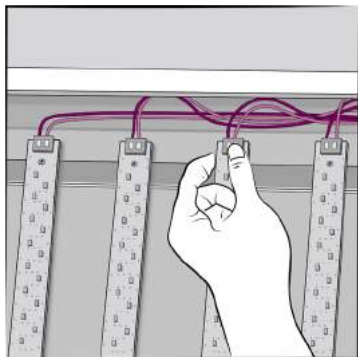

Use the same method to replace the LED lamps on the bottom, bottom corner, back and top light panel.

05

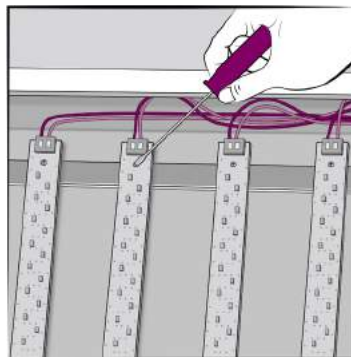

Caution: The LEDs in this system are made to last 38,000 hours. Periodically check for and replace any broken LED crystals, otherwise it can cause others in the same set to malfunction.